



Office Space for **Sublease**

1201 Third

1201 Third Ave | Seattle, WA

Space highlights

- 46,058 RSF contiguous available on Floors 28 & 29
- 23,029 RSF per floor
- Full floor opportunities
- Custom interstitial stair
- Asking rent: \$28.00/RSF gross
- Sublease term through July 31, 2023
- High-end finishes for tech companies
- Furniture available

Building highlights

- Easy access to I-5, Highway 99, I-90 and public transit
- Unobstructed views of Elliott Bay, the Olympic Mountains and downtown Seattle
- Bike storage, fitness facility, conference room and car charging stations

Rob Nielsen

O: +1 206 607 1722

C: +1 206 351 2762

rob.nielsen@am.jll.com

Larry Almeleh

O: +1 206 521 2674

C: +1 206 910 0859

larry.almeleh@am.jll.com



Jones Lang LaSalle Brokerage, Inc.
© 2020 Jones Lang LaSalle IP, Inc.
All rights reserved. All information contained herein is from sources deemed reliable; however, no representation or warranty is made to the accuracy thereof.

1201 Third

Floor 28 | 23,029 RSF

Floor 29 | 23,029 RSF

100
Transit Score

99
Walk Score

Floor 28 | 23,029 RSF

Floor 29 | 23,029 RSF

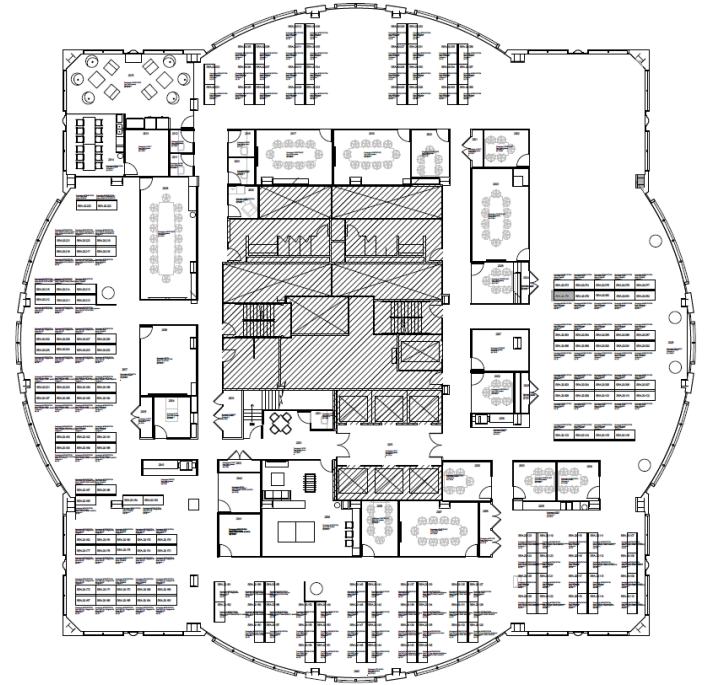
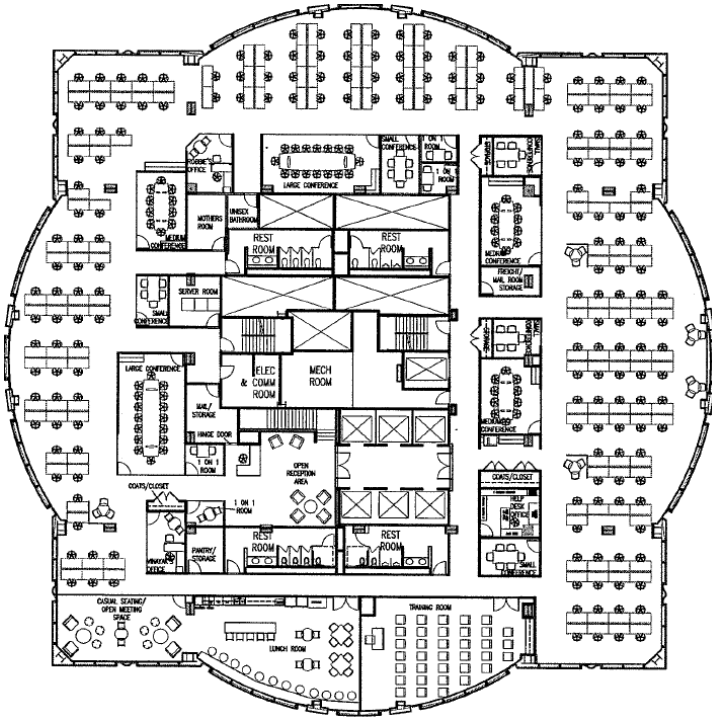

Lease inquiries

Rob Nielsen

O: +1 206 607 1722

C: +1 206 351 2762

Larry Almeleh

O: +1 206 521 2674

C: +1 206 910 0859

