

# 18 WEST MERCER



## SUBLEASE

18W Mercer Street | Lower Queen Anne

**WORK IN STYLE** brand new modern space

**FLEXIBLE TERM** 12-24 months available

**ROOM TO GROW** space from 1,500 - 4,500 sf

1,500 - 4,500  
SQ FT

**\$27**  
FSG

OR

**\$450**  
per desk/mo.

### BUILDING HIGHLIGHTS

- welcoming new lobby and tenant lounge
- easy access for employees to I-5, I-90 or Hwy 99
- amenities including bike storage, showers, indoor parking, pet-friendly building
- steps away from LQA's abundant restaurant & retail scene

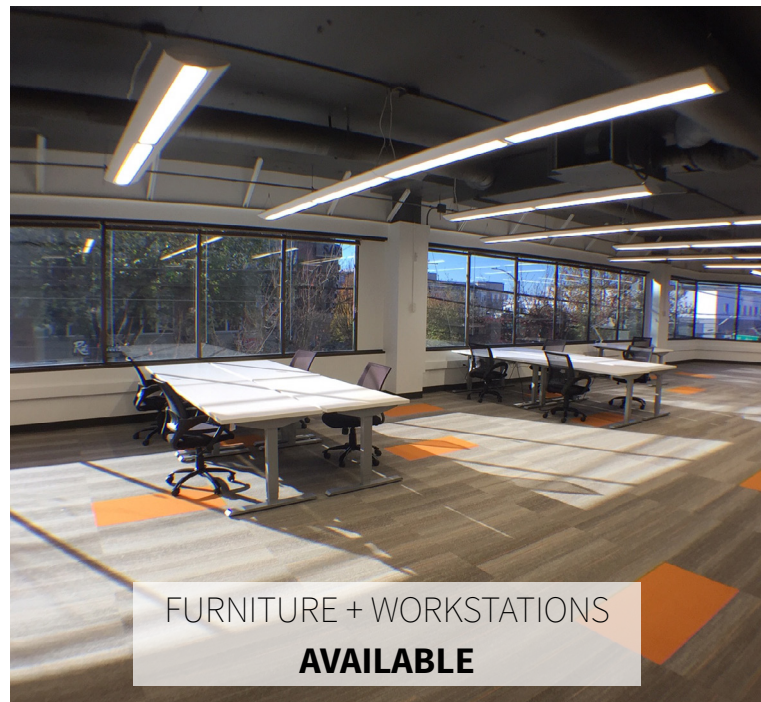

FURNITURE + WORKSTATIONS  
**AVAILABLE**



**Mark To**  
+1 206 521 2666  
mark.to@am.jll.com

**Brooke Dowling**  
+1 206 607 1746  
brooke.dowling@am.jll.com

Jones Lang LaSalle Brokerage, Inc. ©

2019 Jones Lang LaSalle IP, Inc. All rights reserved. All information contained herein is from sources deemed reliable; however, no representation or warranty is made to the accuracy thereof.

# 18 WEST MERCER



1,500 - 4,500  
SQ FT

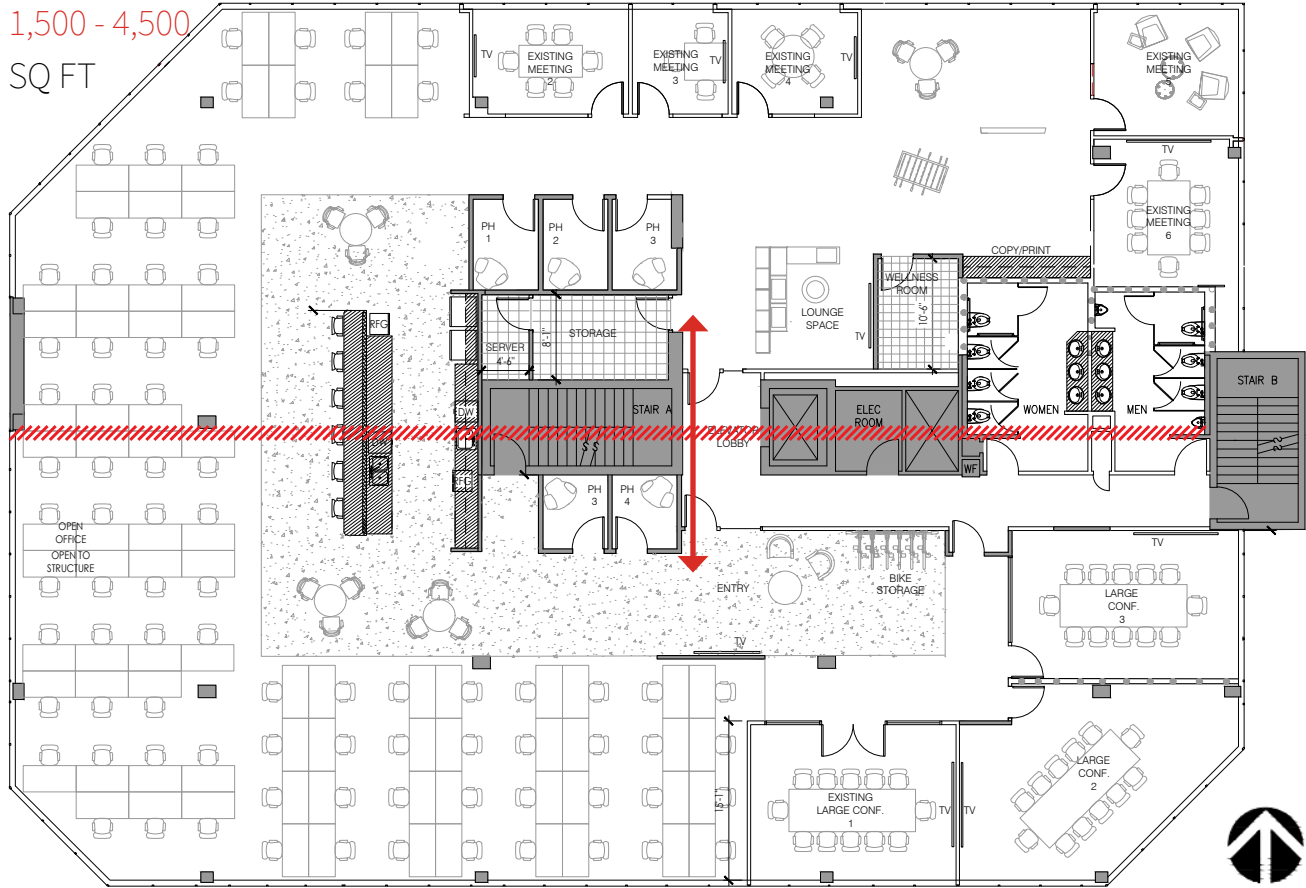

**\*OPTION TO TAKE SPACE ON EITHER HALF\***

**Lease inquiries** Mark To • +1 206 521 2666  
Brooke Dowling • +1 206 607 1746

Jones Lang LaSalle Brokerage, Inc.  
© 2019 Jones Lang LaSalle IP, Inc. All rights reserved.  
All information contained herein is from sources deemed reliable; however, no representation or warranty is made to the accuracy thereof.

