

# 605 UNION STATION



## SUBLEASE

605 Union Station, 2nd Floor | International District

**WORK IN STYLE** plug & play tech space; furniture available

**TIMING** thru October 31st, 2024

**PRIME LOCATION** easy access for employees to all major transportation

19,739  
SQ FT

2 blocks from  
**CENTURY  
LINK**

on-site  
**FITNESS  
CENTER**

seating for  
**195+  
PPL**

Steps from the international districts abundant restaurant scene  
Dough Zone - Samurai Noodle - Momosan - Uwajimaya Grocery

CLICK TO VIEW  
**INTERACTIVE TOUR**



**Brooke Dowling**

+1 206 607 1746

brooke.dowling@am.jll.com

**Clay Nielsen**

+1 206 790 3368

clay.nielsen@am.jll.com

**Blair Stern**

+1 206 521 2668

blair.stern@am.jll.com

# 605 UNION STATION

19,739 SQ FT

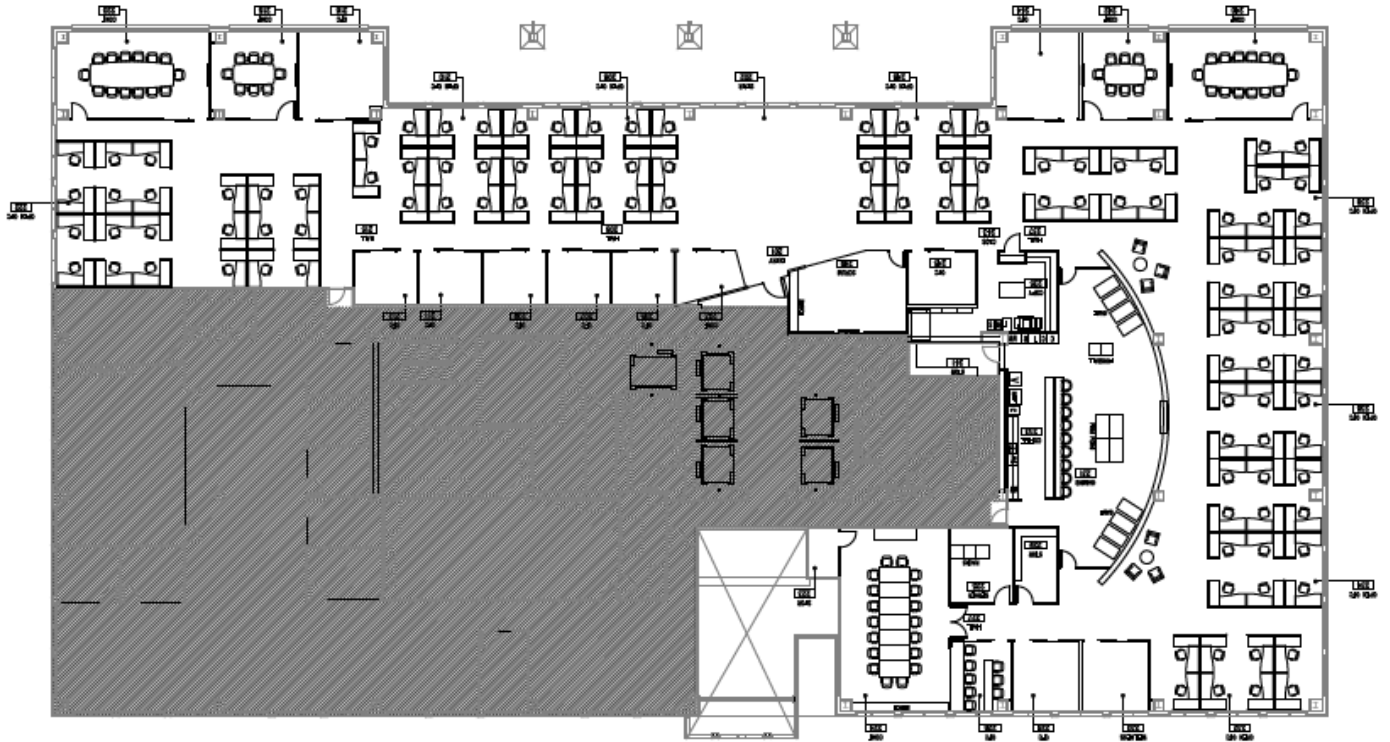

195+ workstations



## Inquiries

Brooke Dowling • +1 206 607 1746  
Clay Nielsen • +1 206 790 3368  
Blair Stern • +1 206 521 2668