

FOR SUBLEASE

3120 139TH AVE SE | BELLEVUE, WA 98005

# SUNSET NORTH CORPORATE CAMPUS

## BUILDING V





## SPACE

# HIGHLIGHTS

- + Available immediately
- + 32,878 RSF on the 2nd floor
- + 27,288 RSF on the 3rd floor
- + Each floor available or together totaling 60,166 RSF
- + 2021 NNN's = \$14.64 / RSF / year
- + Master Lease Expires April 30, 2029
- + Plug and Play ready with furniture available

## BY THE NUMBERS

<b>2ND</b> FLOOR	<b>32,878</b> RSF
<b>3RD</b> FLOOR	<b>27,288</b> RSF



## ADDITIONAL FEATURES



Fitness center / showers & lockers



Nearby park with walking trails and tennis courts



Bright Horizons childcare located across the street



5 minute walk to the Eastgate Park and Ride



On-site cafe



FLOOR PLAN

# SUITE 200 - 32,878 RSF



[CLICK HERE FOR VIRTUAL TOUR](#)

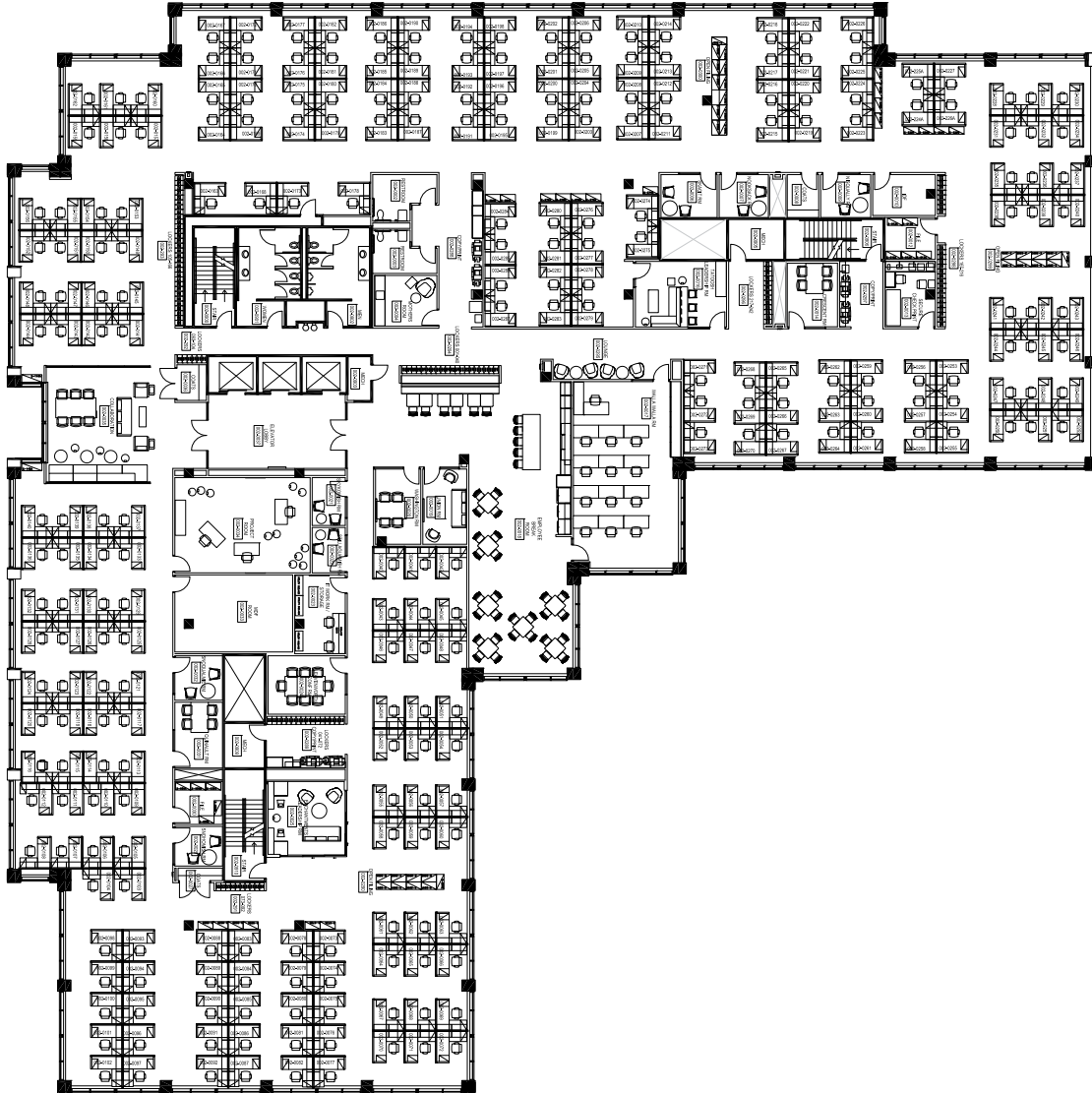

**Sam Ziemba**  
+1 425 974 4005  
sam.ziemba@am.jll.com

**Jake Bos**  
+1 425 974 4086  
jake.bos@am.jll.com

**Mark Flippo**  
+1 425 974 4007  
mark.flippo@am.jll.com

FLOOR PLAN

# SUITE 300 - 27,288 RSF



[CLICK HERE FOR VIRTUAL TOUR](#)

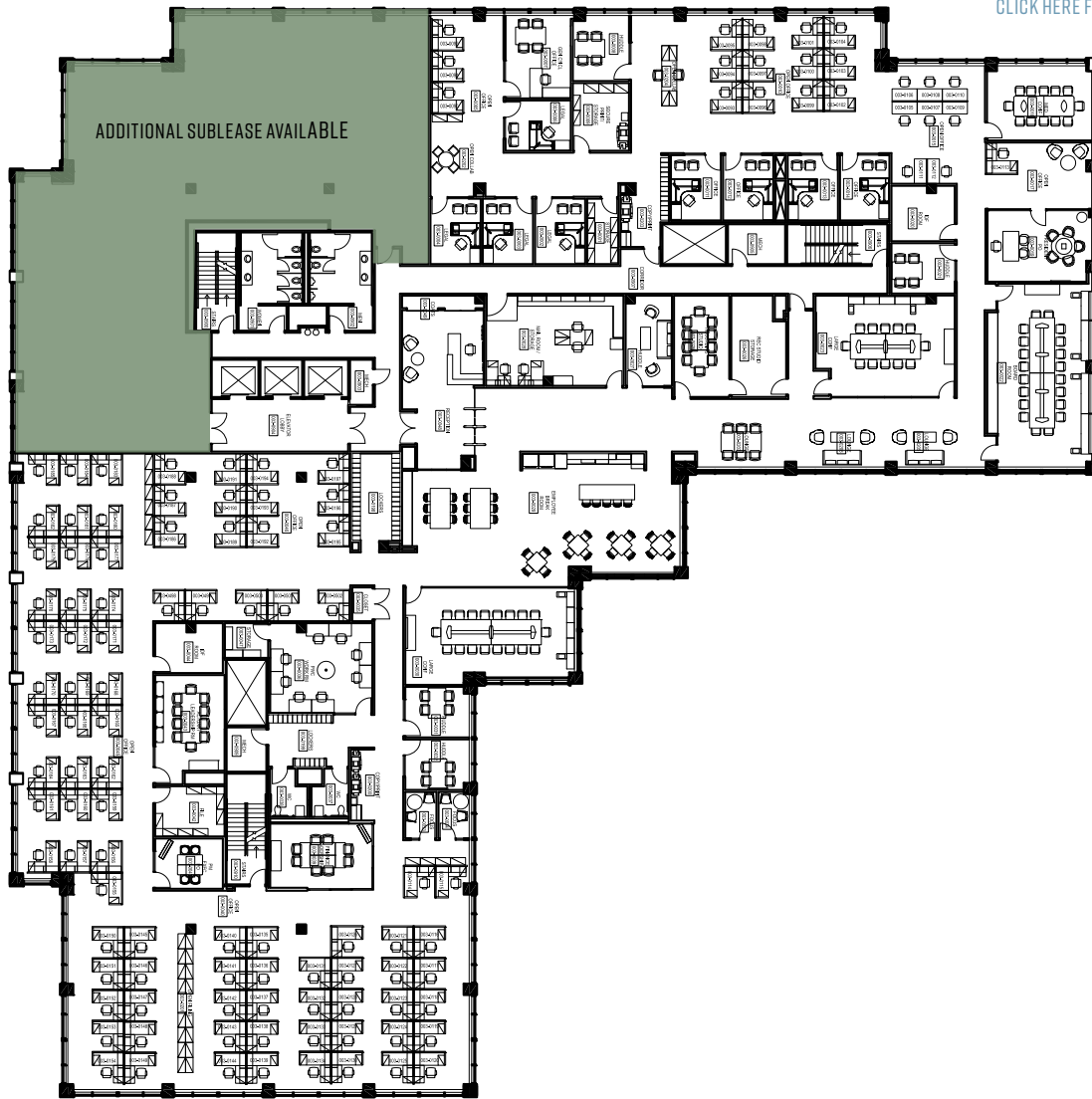

## CONTACT

**Sam Ziemba**  
+1 425 974 4005  
[sam.ziemba@am.jll.com](mailto:sam.ziemba@am.jll.com)

**Jake Bos**  
+1 425 974 4086  
[jake.bos@am.jll.com](mailto:jake.bos@am.jll.com)

**Mark Flippo**  
+1 425 974 4007  
[mark.flippo@am.jll.com](mailto:mark.flippo@am.jll.com)



DISCLAIMER © 2021 Jones Lang LaSalle IP, Inc. All rights reserved. All information contained herein is from sources deemed reliable; however, no representation or warranty is made to the accuracy thereof. Jones Lang LaSalle Brokerage, Inc.